



Ethafoam[®] 2222

Acoustic Insulation Foam

Ethafoam[®] 2222 is a closed-cell polyethylene foam material designed for use as a resilient acoustic insulation layer in concrete floor structures.

Key benefits include:

- Superior impact sound insulation – conforms to European Building Standards.
- Minimal moisture retention – closed-cell structure allows use in humid environments.
- Lightweight – easy to install.
- Low profile installation – minimal increase in floor height.
- Ageing resistant – formulated to withstand degradation caused by alkaline in concrete floors.
- Highly resilient – withstands the rigours of an on-site environment.
- Versatile – can be installed as single or multiple layers dependent on space and performance requirement.

Product Dimensions:

Thickness	5mm
Roll Length	75m
Roll Width	1.5m
Roll Diameter	0.75m
Surface Area of Roll	112.5 m ²

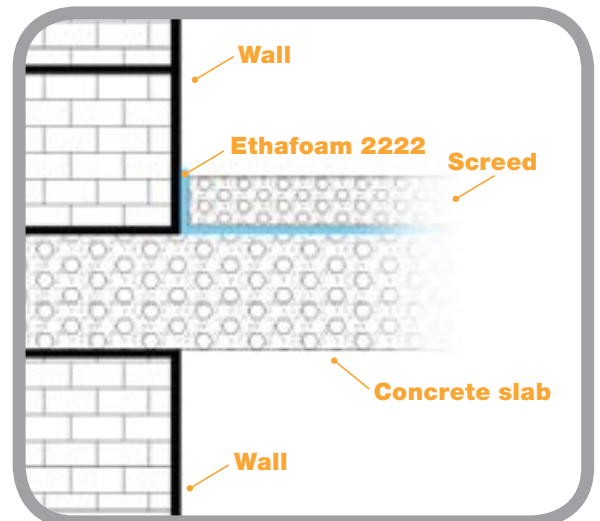

Ethafoam[®] 2222

Acoustic Insulation Foam

PHYSICAL PROPERTIES	TEST METHOD	UNITS	VALUE
Thickness	EN12431	mm	5
Compressive strength 25% Compression 50% Compression	DIN 53577	kN/m ²	23 77
Density	ISO 845	Kg/m ³	33
Impact sound insulation	EN ISO 140-7 EN ISO 140-8	L'nT,w (dB) (dB)	52 20
Airborne sound insulation	EN ISO 140-4	DnT,w + Ctr (dB)	48
Thermal conductivity	ISO8301	W/mK	0.04
Dynamic stiffness	EN29052-1 ISO9052-1	MN/m ²	70
Ageing resistance	SP0414 ISO1798	years	50
Water absorption (after 24 hours)	DIN53428	volume %	0.5

Impact Sound Test Results

TEST METHOD	UNITS	VALUE
En ISO 140-7: 1998	L'nT,w (dB)	52

* Criteria to pass test is less than 60 dB

Impact Sound Insulation

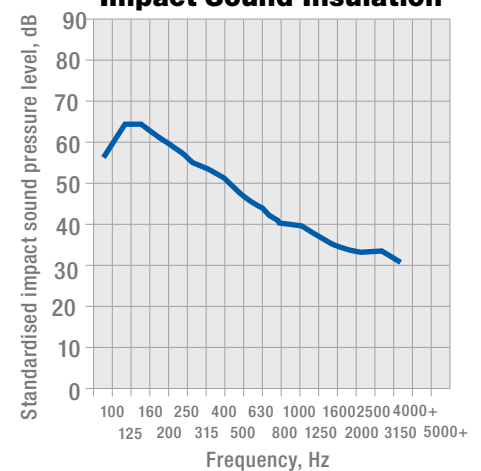

S R L Sound Research
Laboratories Limited

Sound Research
Laboratories Limited
Holbrook House, Little Waldingfield
Sudbury, Suffolk CO10 0TH
Test Report No. C/07/5L/3922/R03

We warrant that Ethafoam 2222 foam will meet our product specifications and will be free from material defects in manufacturing for a period of 90 days from shipment. You agree that our liability under this warranty for any materials sold or delayed in shipment or not shipped, is limited, at our option (a) to repayment, or if not paid, to credit of the purchase price (b) to replacement or (c) to repair and that we shall in no event be liable for general, special, incidental indirect, consequential, punitive or penal damages. The user should test the application to determine the suitability of Ethafoam 2222 foam for the intended use. There are no warranties or representations of any kind, express or implied, including any warranties of fitness for a particular purpose or merchantability, except the foregoing express warranties and none shall be implied by law. All warranties, express and implied, are excluded when the material is sold "as is".

Sealed Air

Specialty Materials
Telford Way
Kettering NN16 8UN
United Kingdom
+44 1536 315700 Fax: +44 1536 410576
www.sealedair-emea.com

Corporate offices: Sealed Air Corporation,
200 Riverfront Boulevard, Elmwood Park, NJ 07407, USA
www.sealedair.com

© Reg. U.S. Pat. & TM Off. © Sealed Air Corporation (US) 2008. All rights reserved.